



Everything's Included[®] Homes

The Sheffield

4 Bedroom / 3 Bath / 3 Car Garage

2805 sq. ft. living

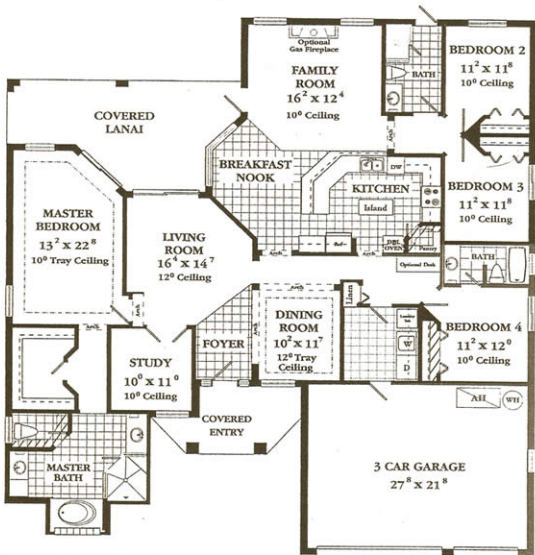

TOTAL LIVING AREA.....	2805 <i>sf</i>
GARAGE.....	657 <i>sf</i>
LANAI.....	310 <i>sf</i>
ENTRY.....	147 <i>sf</i>

E-804

The specific features in a home may vary from home to home and from one community to another. We reserve the right to substitute equipment, materials, appliances and brand names with items of equal or higher, in our sole opinion, value. Color and size variations may occur. The prices of our homes, included features, and available locations are subject to change without notice. Please see the actual home purchase agreement for additional information, disclosures, and disclaimers relating to the home and its features. Void where prohibited by law.



Lennar - Clermont

1635 E. Highway 50 • Suite 200 • Clermont, FL 34711

www.lennar.com/clermont

© 2004 Lennar Inc. 0182

